

Professional installation guide

mflor Dryback design floors

GB

General guidelines for for Dryback

Please contact your mflor supplier if you are unsure about any part of the installation and maintenance instructions and the full warranty terms. Mflor Dryback is a flexible vinyl floor that is soft, warm, quiet and comfortable underfoot and specially designed for full gluing to the screed with different types of glue or on a self-adhesive underlay. The choice of a type of glue or self-adhesive sub-floor in combination with mflor Dryback is determined by the area of application and external conditions of the installation.

National requirements

When installing mflor Dryback floors, national specifications must always be applied in accordance with the installation standards of floorings as described in BS 8203 in the United Kingdom, VOB Part C, DIN 18365 in Germany and all other relevant European, national and local standards.

Transport and storage

Boxes containing mflor Dryback should always be stored and/or transported on a flat and firm surface, in neat stacks, flat, not overhanging and never vertically. The boxes must never be stored in very cold (below 2°C) or very warm conditions (above 35°C) or in damp rooms. The recommended temperature is between 15°C and 25°C.

Product control

Mflor Dryback is checked carefully before it leaves the factory. This allows us to guarantee high standards of quality. Mflor Dryback should always be inspected before installation. Check the batch number on the short side of each package and check that all the material has come from the same batch. Minor variations in colour across the same batch number help give mflor Dryback its natural look. To avoid intrusive colour variations, we recommend that you do not install material from different batch numbers over large areas or within the same room. Check the boards for visible breaks during installation. Do not install boards that show any imperfections and get in touch with your mflor contact person immediately. Mflor is not liable for complaints in case of visible defects before installation.

Suitability

- Mflor Dryback is only suitable for indoor use.
- Mflor Dryback can be laid on various hard, flat floors such as sand cement, anhydrite (calcium sulphate), wood and ceramic tiles which have been suitably prepared (see screed preparation) and comply with national regulations.
- Mflor Dryback can be used with traditional water-based underfloor heating and cooling. Use with electric underfloor heating with an on/off switch is not recommended.

Underfloor heating

Mflor Dryback is ideal for water-based underfloor heating or cooling. However, make sure that the surface of the screed is not warmer than 28°C.

For new underfloor heating, there are general start-up instructions or a “start-up and cooling protocol”. Check with your client whether the start-up and cooling protocol has been carried out.

3-season-/non-climate-controlled environments

Mflor Dryback flooring is suitable for 3-season or non-climate-controlled environments as long as it is applied with a suitable glue.

Conservatories

Mflor Dryback is not suitable for locations that may be exposed to extreme, direct heat, such as conservatories with glass roofs and/or walls. Temperatures can rise extremely rapidly, so that the floor can easily exceed 45°C, leading to slight deformation of the panels and/or discolouration of the design. If there is a wood-burning stove or open fireplace, the proper protection must be used so that the mflor Dryback floor is not exposed to extreme heat in the immediate vicinity of the heat source.

Important factors for installation

Evenness tolerances of flooring	Max. height difference 3 mm over 1.8 metres or 5 mm over 3 metres.
Vapour-tight membrane - 0.20 mm	Not required, but advisable with a screed that is not dry*.
Sub-floor required	No
Acclimatisation requirements	Acclimatise in the room in which the flooring is to be installed for a minimum of 24 hours.**
Installation over ceramic tile floor	Not without preparation
Installation by gluing	See installation guide
Maximum permitted residual moisture percentage of the screed	< 0.3% anhydrite with underfloor heating < 0.5% anhydrite without underfloor heating < 1.8% sand cement with underfloor heating < 2.0% sand cement without underfloor heating < 14% wood and MDF
Suitable for underfloor heating	Approved - temperature of the screed surface must not exceed 30°C.
3-season/non-climate-controlled environments	Suitable
Expansion requirements	None, mflor Dryback may be installed and sealed tight (but stress-free) against walls, frames and objects.
Optimum ambient temperature and relative humidity conditions	During installation: between 18°C and 28°C During lifetime: between 6°C and 35°C Relative humidity: between 40% and 70%
Definition of water-resistant	The dimensional stability, rigidity and thickness must not decrease due to contact with moisture/water.

* A vapour-tight film prevents moisture coming into contact with the back of the mflor Dryback floor. We are not responsible for any deterioration of the screed and/or the occurrence of mould. Inform your glue and levelling compound supplier in case of structural or design-related moisture problems.

** Acclimatisation allows mflor Dryback to reach the ideal handling temperature and relieves the material of any stresses occurring, for example, during transport, storage or installation.

CAUTION

Only those installation techniques described in this installation guide are covered by the warranty. No guarantee is given for customised mflor Dryback installations.

Screed preparation

Checking and pre-treatment of screed:

Ensure that the (background) information about the composition, construction and quality of the screed is correct. The screed must be kept dry, level and clean, as described in DIN 18365. The screed must also be compression- and tension-resistant. Seek advice on the right type of moisture protection, primer, levelling compound and sub-floor required for professional screed preparation and installation.

In principle, all types of floor screed must be **primed and levelled** because the slightest unevenness in the sub-floor will otherwise impact on the finished floor. Also, a professionally levelled screed ensures even glue absorption capacity, resulting in optimal adhesion.

Evenness of screed

The screed must be flat and not have any unevenness greater than 3 mm within a radius of 1.8 metres or 5 mm within a radius of 3 metres. The screed must not slope by more than 25 mm over 1.8 metres in one or more directions.

Influence of slopes

If the slope is greater than 1 mm over 1.8 metres or 3 mm over 3 metres, this can affect the installation, which can manifest itself in small (wedge-shaped) gaps between the panels.

Moisture protection

Moisture protection for levelling is not necessary when the screed is permanently dry. Contact your glue and levelling compound supplier for expert advice if the screed is not permanently dry.

Underfloor heating

Make sure that the ambient temperature and the temperature of the screed are comfortable during acclimatisation and installation. If necessary, lower the water temperature of the underfloor heating by setting the pump thermostat to 20°C. If heating pipes heat the screed to a temperature higher than 30°C, mflor Dryback may discolour from underneath. Prevent this at all times by using a thicker levelling layer and a suitable sub-floor and/or by adjusting the water temperature in the pipes.

Residual moisture content of screeds

Maximum permitted residual moisture percentage of the screed:

- < 0.3% anhydrite with underfloor heating
- < 0.5% anhydrite without underfloor heating
- < 1.8% sand cement with underfloor heating
- < 2.0% sand cement without underfloor heating
- < 14% wood and MDF

Acclimatisation

Mflor Dryback should be acclimatised in the room where it is to be installed for at least 24 hours prior to installation, or until the product has reached the ambient temperature. The minimum temperature is 18°C. Ensure that the packages are laid flat and without stress during acclimatisation. Leave the panels in the packaging in small stacks away from sources of extreme heat or cold. The acclimatisation environment should be between 18 and 28°C during this period and should be maintained within these levels after installation to ensure an optimum end-result. Acclimatisation allows mflor Dryback to reach the ideal handling temperature and relieves the material of any stresses occurring, for example, during transport, storage or installation.

REMARKS

PVC floors may expand and shrink under the influence of temperature or climatic conditions. If the PVC is not properly acclimatised or if the temperature fluctuates by more than 10°C over 12 hours, raised joints may occur in the PVC floor which can cause irreparable damage. This can be prevented by following the installation instructions correctly.

Temperature conditions before, during and after installation

It is best to install mflor Dryback at a room temperature between 18°C and 28°C and a floor temperature above 15°C. Installation in spaces that are colder than recommended will adversely affect the user-friendly installation features of mflor Dryback. The panels are less easy to handle and less flexible, and cutting will be more difficult, making it harder to cut out small pieces. The lower the temperature, the harder they are to handle. For installation in spaces that are warmer than the recommended temperature conditions, we recommend that you create the correct installation conditions by using fans, blinds, etc.

A constant temperature must be maintained during acclimatisation, installation and 72 hours after installation. The temperature must not fluctuate by more than 5°C per day and must remain within the required room temperature of at least 18°C and no more than 28°C. The floor temperature must not drop below 15°C.

Type of bonding

Mflor Dryback can be installed with all regular brands of glue, as long as the relevant supplier states that the glue is suitable for PVC strips, tiles and/or mosaic. You can choose the most suitable glue from your supplier's range, depending on the type of screed, external conditions, field of application and/or PVC format. You can choose from dispersion glue for PVC, fibre-reinforced adhesive, PU or 2K glue for PVC, or alternatives such as a drying adhesive or a self-adhesive floating sub-floor.

Type of glue for large sizes

When installing strips longer than 140 cm and tiles larger than 65 x 65 cm, the strips and tiles must always be installed using a wet glue, such as Uzin KE-66, 646 Eurostar Premium or similar.

Rolling after gluing

For optimal glue transfer and adhesion, roll the installed floor immediately with a roller of at least 50 kg.

Installation plan

Lay out a chalk line according to the size of the strips/tiles to be installed, so as to ensure optimum area distribution and to minimise cutting losses. We recommend that you draw up a working plan beforehand showing how you intend to install the strips or tiles in the room in question.

Avoid colour differences

We recommend using only material from the same batch in each room and mixing the packs together to create as realistic an image as possible. The arrows on the back of the product only have to be followed in the case of tiles larger than 65 x 65 cm.

Step by step installation instructions

General

Decide the installation method based on the above installation guide for each application and area.

Carry out the installation starting from the middle of the room/area and work towards both ends from the middle. Never start directly against a wall with the first row of boards or tiles as they may be uneven and therefore negatively affect the installation.

REMARKS

The most common and easiest way of working with strips is to start in a perfectly straight line through the middle of the longest length of the room and then work to left and right.

With tiles, we always recommend starting from a point as close as possible to the centre of the room. Working from a central point towards the outside ensures that the last rows of tiles are the same width on both sides.

Decide the direction in which you are going to lay the mflor Dryback floor – it is usual to lay the rows working towards the window. Measure the width of the room accurately and calculate an even distribution of the first and last rows. Then draw a starting line on the floor using a pencil, chalk line or laser along which you lay the first row.

Installing mflor Dryback flooring

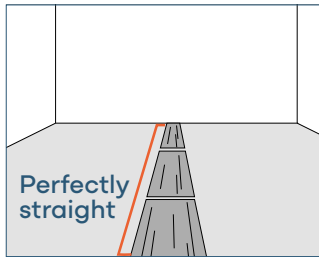

1

Glue the first measured and marked part according to the manufacturer's instructions. Observe the correct opening time and processing time. Place the mflor Dryback panels exactly along the perfectly straight starting line.

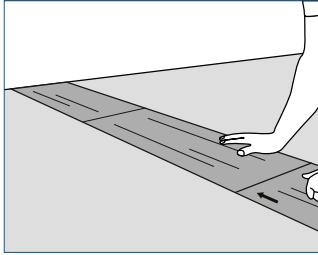

2

Lay the panels without stress and adjoining each other. When laying large tiles, follow the direction of the arrows on the back.

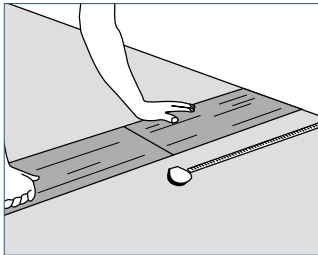

3

Measure the last panel of the first row carefully and place it without stress against the wall or skirting.

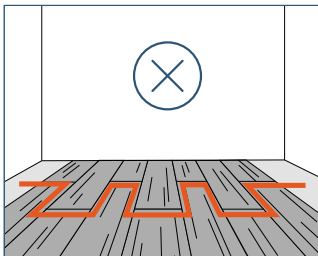

4

For a natural look, we recommend that the piece left over from the first row should not be used as the first piece of the second row. Avoid having a recognisable, repeating distance between the panels, which creates a kind of staircase effect. Boards are installed randomly and tiles can be installed in a straight line, in a half-brick bond or in an irregular bond.

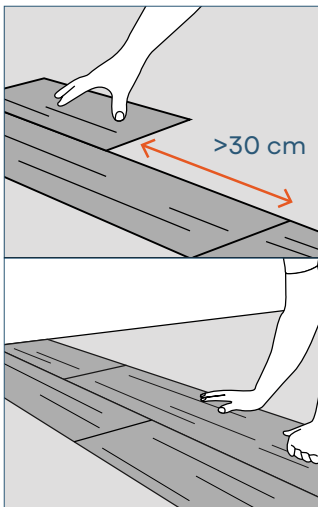

5

For the second and each subsequent row, take a new panel and decide how large the panel should be (or use a piece left over from one of the previous rows). With boards, make sure that the joint of the short side is at least 30 cm from the joint of the short side of the previous row; and at least 20 cm in the case of tiles.

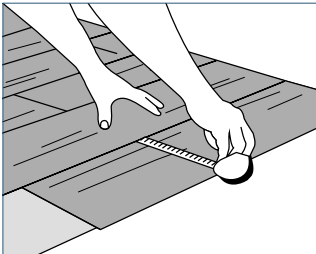
	6	Place the second and each subsequent row without stress and adjoining the previous row.
	7	Cut the last row along the wall or any obstacles by measuring accurately or using contour jigs. Lay the last row without stress between the previous row and the wall, without one panel being too tight and pushing other panels away.

REMARKS

Never use solvents for removing adhesive residue. Remove adhesive residue with a moist cloth straight away. Soak dried glue stains using hot water and a soft brush and remove using a damp cloth.

Protect your floor by fitting the appropriate Scratch no More protective caps to all sliding furniture and felt glides on furniture that is moved occasionally.

For optimum protection of your floor after installation, carefully read and observe the mflor maintenance instructions, particularly in situations of intensive use.

Installation of mflor Dryback Parva herringbone floors

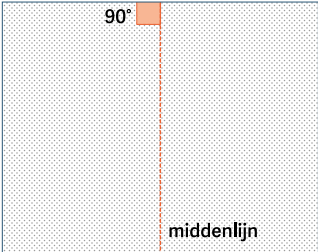
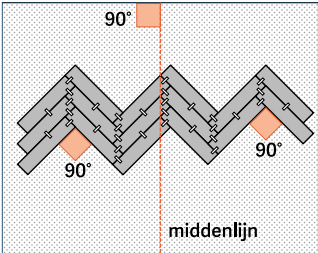
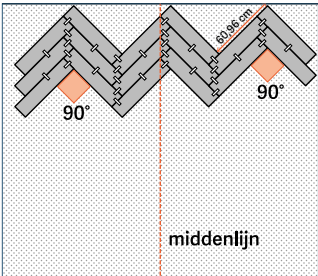
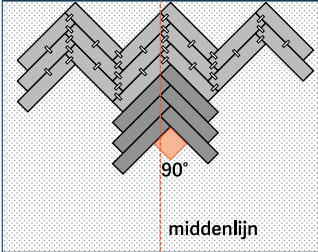
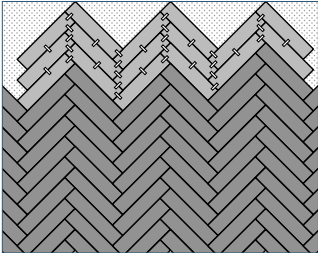
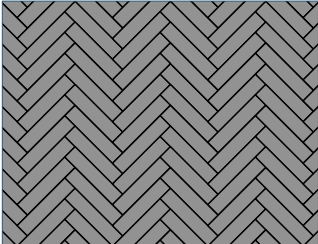
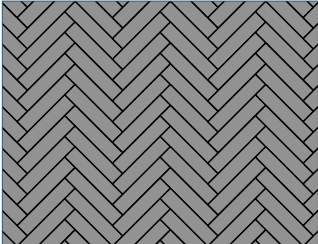
	<p>1</p> <p>Identify the centre of the room (viewed from the starting wall) and make a line at right angles to the starting wall using a chalk line. This is the centre line.</p>
	<p>2</p> <p>Lay two or three rows of strips against each other. Make sure that the corners are exactly 90° and fasten the strips tightly together with tape.</p>
	<p>3</p> <p>Lay the joined strips against the starting wall, with the points straight on the centre line.</p>
	<p>4</p> <p>Check that all angles are 90° and that the distance to the starting wall is 22.86cm (Parva Parquet) or 60.96cm (other Parva collections).</p>
	<p>5</p> <p>Apply glue to the floor across a width of two strips and lay these two strips on the glue. When doing so, carefully follow the glue manufacturer's instructions regarding opening time and application time.</p>
	<p>6</p> <p>Repeat this procedure to the left and right of the laid starting strip. Continuously check that all angles are still 90°.</p>
	<p>7</p> <p>Remove the strips stuck together with tape and lay the floor close against the starting wall.</p>



REMARKS

Never use solvents for removing adhesive residue. Remove adhesive residue with a moist cloth straight away. Soak dried glue stains using hot water and a soft brush and remove using a damp cloth.

Protect your floor by fitting the appropriate Scratch no More protective caps to all sliding furniture and felt glides on furniture that is moved occasionally.

For optimum protection of your floor after installation, carefully read and observe the mflor maintenance instructions, particularly in situations of intensive use.

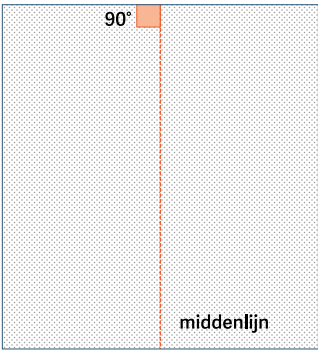
Installation of mflor Dryback Parva Chevron

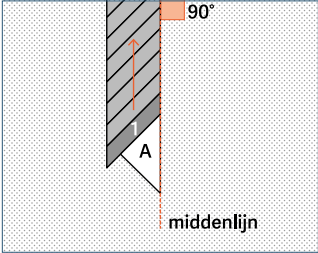
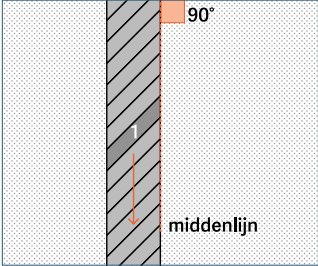
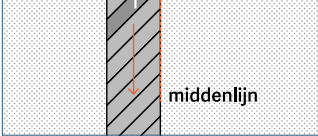
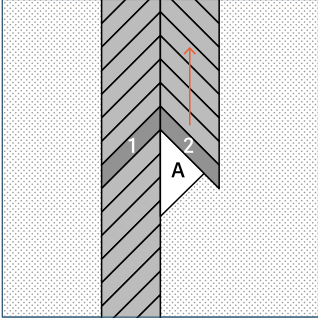
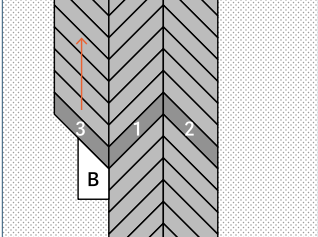
	<p>1</p> <p>Identify the centre of the room (viewed from the starting wall) and make a line at right angles to the starting wall using a chalk line. This is the centre line.</p>
	<p>2</p> <p>Cover a section of the floor to the left of the centre line with glue over a width of one strip. When doing so, carefully follow the glue manufacturer's instructions regarding opening time and application time.</p>
	<p>3</p> <p>Lay guide piece A with 45° corners along the centre line, making sure that guide piece A is not on the glue. Then lay the first row of strips on the glue. Begin with the starting strip and then install the strips above the starting strip.</p>
	<p>4</p> <p>Remove guide piece A and apply glue to the floor below the starting strip. Then lay the strips below the starting strip on the glue.</p>
	<p>5</p> <p>Check that this starting row runs straight along the centre line and that all strips are correctly aligned.</p>
	<p>6</p> <p>When the starting row is properly fixed, continue with the second row, to the right of the starting row. Start again with the starting strip, using guide piece A. Again, work first upwards and only then downwards.</p> <p>NOTE: It is very important to ensure that a row is properly fixed before laying a new row against it. If a row is not properly fixed, the strips can shift, which makes it impossible to lay a tightly fitting pattern.</p>
	<p>7</p> <p>Continue with the row to the left of the starting strip, using guide piece B with the 135° angle. Again, work first upwards and then downwards.</p>

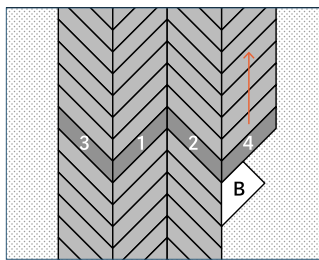

8

Then install the row on the right-hand side using guide piece B.

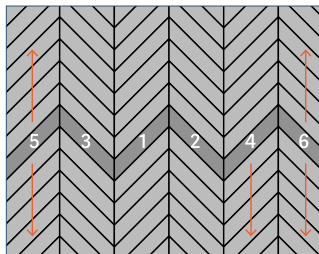

9

Continuously check that all strips are perfectly straight and the angles are always 90°. Keep repeating this sequence until the floor is finished.

REMARKS

Never use solvents for removing adhesive residue. Remove adhesive residue with a moist cloth straight away. Soak dried glue stains using hot water and a soft brush and remove using a damp cloth.

Protect your floor by fitting the appropriate Scratch no More protective caps to all sliding furniture and felt glides on furniture that is moved occasionally.

For optimum protection of your floor after installation, carefully read and observe the mflor maintenance instructions, particularly in situations of intensive use.

General care and maintenance

Preventive measures

Prevention is better than cure. Prevent the top layer from getting scratched by sliding furniture without (or with rough) furniture glides. Protective caps from e.g. Scratch no More prevent hard, rough materials such as road dirt or sand from scratching your floor. Install a suitable entrance mat or barrier mat with a plasticiser-resistant backing. This will provide protection against road dirt and moisture that will unnecessarily damage and/or soil the floor. This in turn means you will have to clean the floor less often and its lifetime will be extended.

Prevent discolouration

Any floor covering, whether wood, PVC or carpet, is liable to discolour under the influence of ultraviolet rays in sunlight. To prevent discolouration of your mflor Dryback floor, it is important to use effective blinds.

Avoid contact with rubber

Contact between PVC and rubber should be avoided as far as possible, unless the floor is protected with Dr. Schutz Anticolor coating. Long-lasting contact between PVC and rubber (e.g. a rubber ring underneath a rubbish bin, rubber barrier mats, place mats, etc.) may cause permanent, dark-brown discolouration. Rubber caps under furniture can cause streaks due to friction. Check whether your furniture and other objects have rubber caps and apply the necessary protection (see www.scratchnomore.nl).

Points to be aware of

- Use barrier mats with a plasticiser-resistant backing at all entrances.
- Avoid contact between PVC and rubber (unless protected with Dr. Schutz PU Anticolor).
- Do not slide heavy objects across the floor and make sure all your sliding furniture is properly protected.
- Replace any castors under office chairs with soft castors suitable for smooth vinyl/PVC floors.
- Clean up spillages as soon as possible.
- Prevent lasting exposure to direct and intense sunlight.

Cleaning and maintenance advice

Thanks to the advanced production process, the use of only high-quality raw materials and the PU protective layer, mflor PVC strips and tiles are highly wear-resistant and easy to clean. Mflor Dryback is scratch-resistant but not scratch- or maintenance-free. To ensure that you continue to get maximum benefit from your floor, we advise you to follow the maintenance advice given below.

Daily maintenance

- Remove spillages as soon as possible.
- Remove loose dirt by sweeping, dusting or vacuuming the floor with a soft nozzle.

Weekly maintenance

- Clean the floor with a mop or floor cloth. Use a solution of lukewarm water and mflor Cleaner Mat or Dr. Schutz PU Cleaner. At the correct dosage of 5 ml per litre of water (1:200), this will leave no residue on the floor.
- Leave the floor as dry as possible.

Periodic maintenance

If mflor Dryback is not completely clean after weekly cleaning, you can carry out a periodic (deep) clean. We recommend you carry out this cleaning at least once a year. Use Dr. Schutz Basisreiniger R at a dosage of 100 ml per litre of water (1:10). Wet the floor thoroughly with this solution using a flat mop or floor cloth. Leave it to work for about 15 minutes and remove the dirty water, e.g. with a wet vacuum or clean mop or floor cloth. In case of very heavy soiling, use a single-disc scrubbing machine with a red cleaning pad.

IMPORTANT: Afterwards, mop the floor with a damp cloth using mflor Cleaner Mat in a ratio of 5 ml per litre of water (1:200) and allow to dry.

Points to be aware of

- Never use all-purpose cleaner, laminate cleaner, household soap, oil-based soap, green soap, vinegar, polishes, waxes, abrasives or aggressive agents such as chlorine, toilet cleaner, lime or other corrosive detergents or solvents when cleaning mflor Dryback.
- Do not use steam cleaners on mflor Dryback.
- A large amount of diluted dirt and detergent remains on a floor that stays wet for a long time after cleaning. The floor will seem to get dirty again very quickly because the previous dirt was not completely removed.
- An mflor Dryback floor can be slippery when wet.
- Do not place rugs or other impervious materials on the wet floor. These can cause discolouration or condensation in the top layer.

Project environments

Mflor Dryback can be deep-cleaned in project environments when necessary. This can be done with a soft or hard brush, a buffer and a white cleaning pad, or a scrubber-suction machine and a white cleaning pad. Use a suitable, neutral detergent that does not leave any residue, such as Dr. Schutz PU cleaner or similar. Ask your mflor supplier, professional cleaning service or Dr. Schutz for detailed advice.

Preventive protection

Although mflor Dryback has a PU protective layer, as a preventive measure you may wish to protect your floor with an extra hard PU protective layer or PU Anticolor. We recommend this in every case for applications such as industrial rooms, laboratories, showrooms (for cars, motorcycles, mopeds, bicycles, etc.), hairdressing salons and all other applications where external influences can discolour the top layer. For more information about these maintenance products, please Dr. Schutz.

Manufacture or extra protection

To repair minor scratches or apply an additional preventive layer (to help your floor last longer), we recommend Dr. Schutz. For more information about these maintenance products, contact Dr. Schutz.

If in any doubt, always contact your mflor supplier or Dr. Schutz for detailed advice.

www.dr-schutz.com